

# 123.045

## Planeador

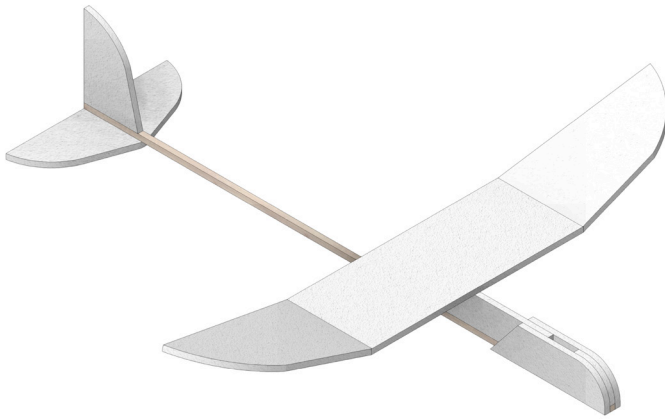

### Herramientas necesarias:

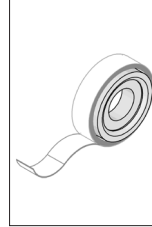

Cinta adhesiva

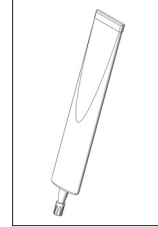

Pegamento universal

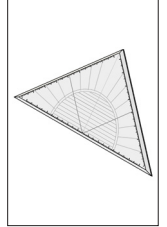

Escuadra

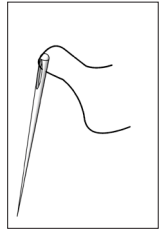

Aguja

### NOTA:

Las maquetas de OPITEC, una vez terminadas, no deberían ser consideradas como juguetes en el sentido comercial del término. De hecho, se trata de material pedagógico adecuado para un uso didáctico. Es imprescindible la supervisión de un adulto. Kit no adecuado para niños menores de 3 años, dado que existe el riesgo de asfixia por piezas pequeñas.

Lista de piezas	Cantidad	Medidas (mm)	Aplicación	Nº de pieza
Espuma rígida perforada	1	410x114x3	Piezas sueltas	1
Listones de madera	1	310x3x3	Transportador	2
Bola de acero	20		Contrapeso	3
Papel de lija	1		Acabado de los bordes	4

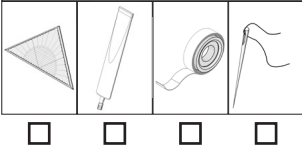
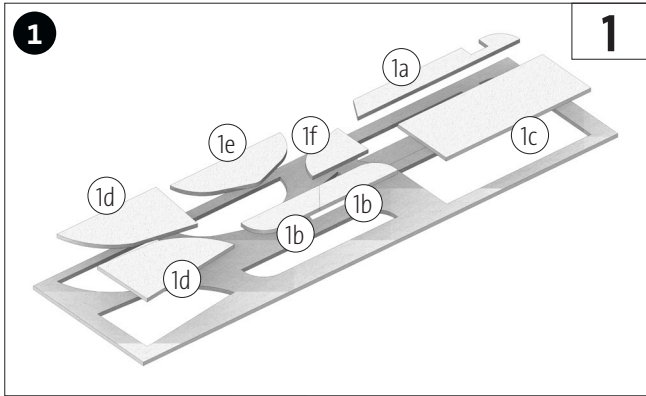

---

---

---

---

---

---

---

---

---

---

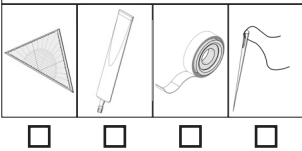
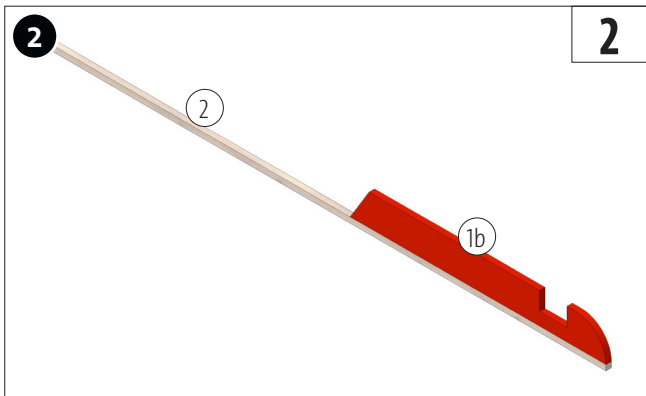

---

---

---

---

---

---

---

---

---

---

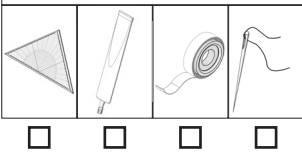
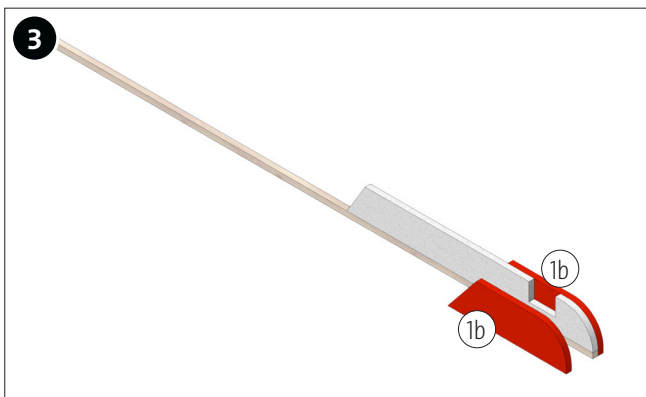

---

---

---

---

---

---

---

---

---

---

Instrucciones de montaje 123.045  
Planeador

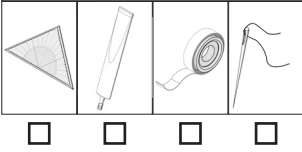
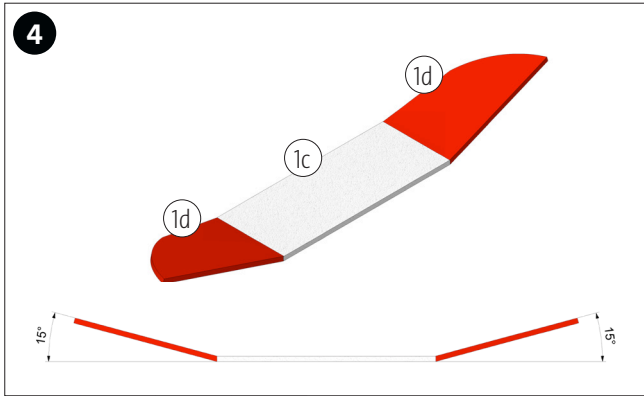

---

---

---

---

---

---

---

---

---

---

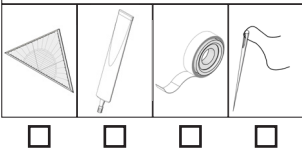
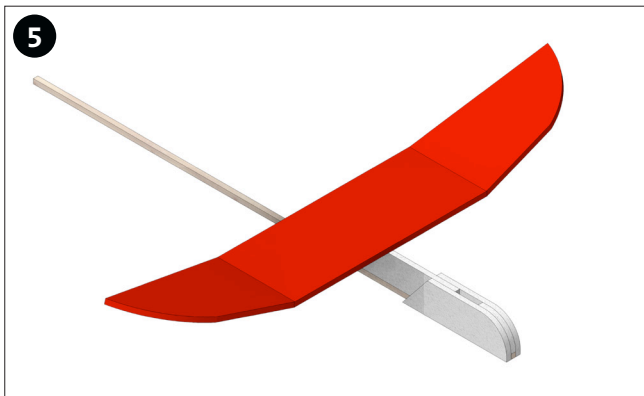

---

---

---

---

---

---

---

---

---

---

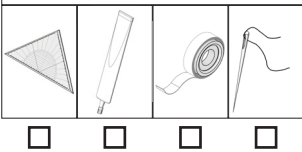
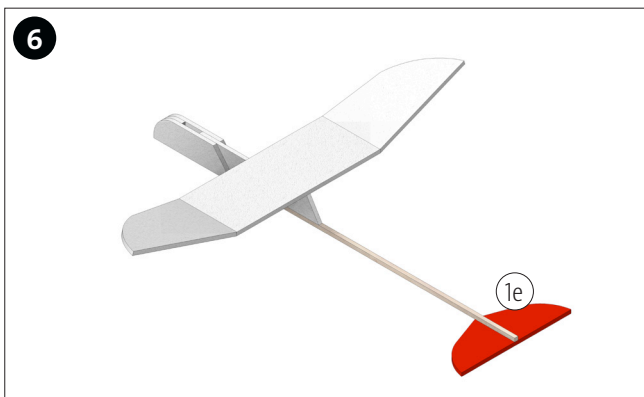

---

---

---

---

---

---

---

---

---

---

Instrucciones de montaje 123.045  
Planeador

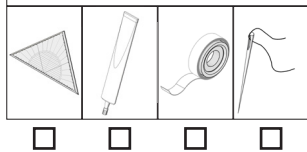
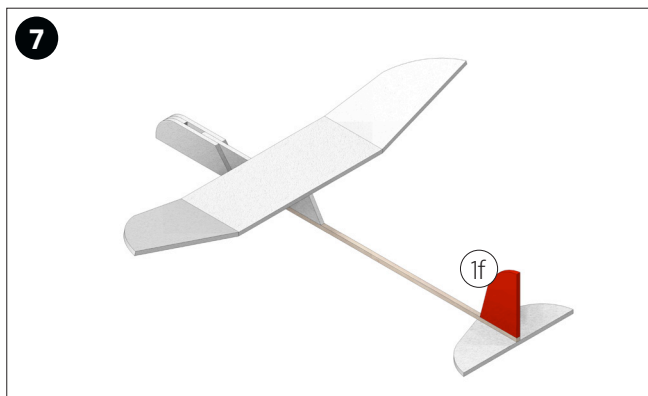

---

---

---

---

---

---

---

---

---

---

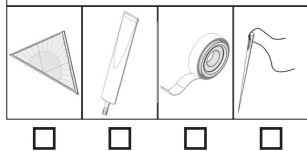
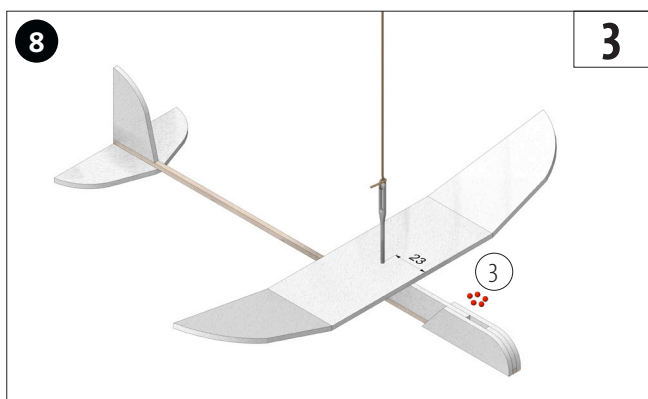

---

---

---

---

---

---

---

---

---

---

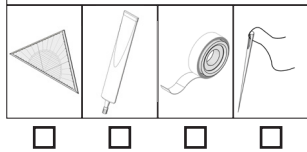
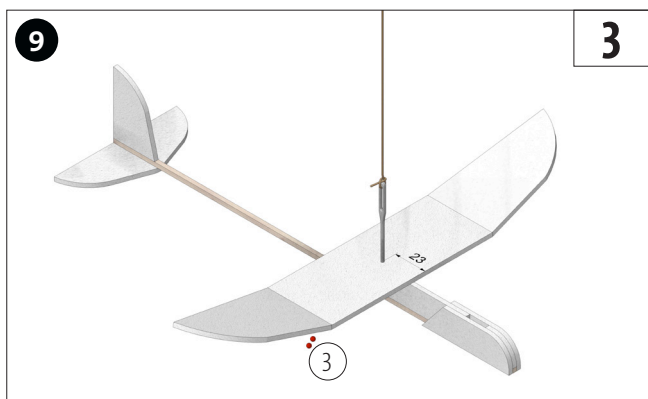

---

---

---

---

---

---

---

---

---

---

10

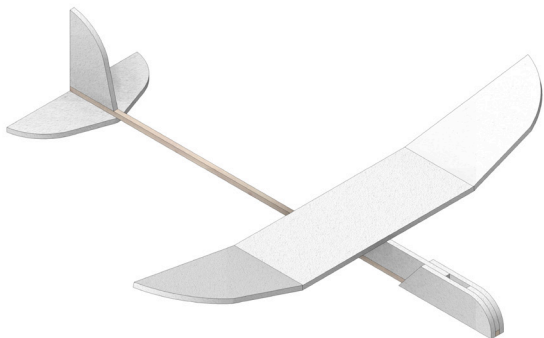

---

---

---

---

---

---

---

---

---

---